

Sono Meet L

Meeting Pod

Design — Iiro Viljanen



The soundproof Sono Meet L meeting pod is ideal for meetings of 4–6 people, and its size allows it to be furnished for various other purposes, such as a workstation, a team workspace, or even a compact break room. Charging points for devices can be placed either on the side walls or on the optional middle panel, which can also be equipped with a monitor mount. Standard features include casters for easy movement, as well as motion sensor-controlled adjustable lighting and ventilation. The door position can be chosen either at the edge of the glass wall or in the center.



MATERIAL DESCRIPTION:

Exterior:

Sound-absorbing laminated glass
Acoustic walls and ceiling
Glass frames black painted aluminium
Exterior surface (sides) melamine (oak or black wood imitation)

Interior:

Carpet, dark grey
Walls and ceiling felt, dark grey

ACCESSORIES:

- Power socket, charging USB-C (30W or 65W) and RJ45
- Middle panel (black melamine) with monitor mount and charging points
- Table and chairs

WEIGHT:

949 kg

FEATURES:

- Castors
- Levelling glides
- Adjustable LED lighting and air circulation system with occupancy sensor
- The power cord location can be selected during installation (upper or lower part of the pod)
- Door position can be selected

CARBON FOOTPRINT:

Sono Meet L: 1790.70 kg CO₂e

DIMENSIONS:

Weight: 949 kg

Room height min.: 230 cm

Power cable length: 200 cm

Dimensional drawing:

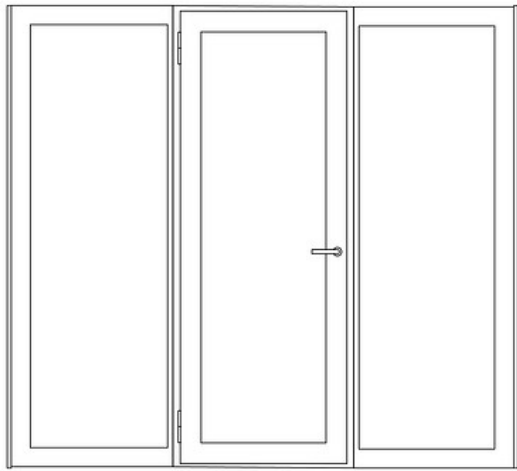

244

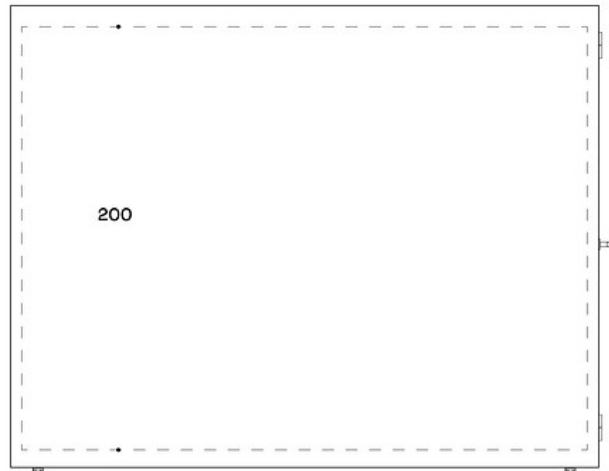

220

200

280

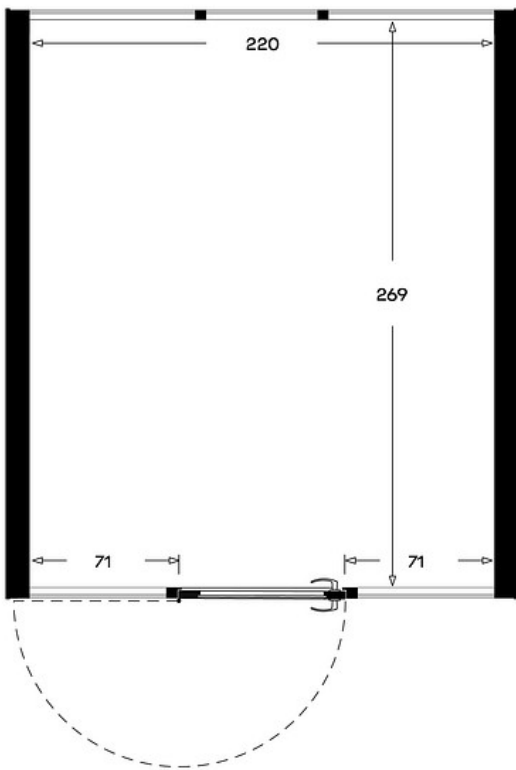

220

269

71

71

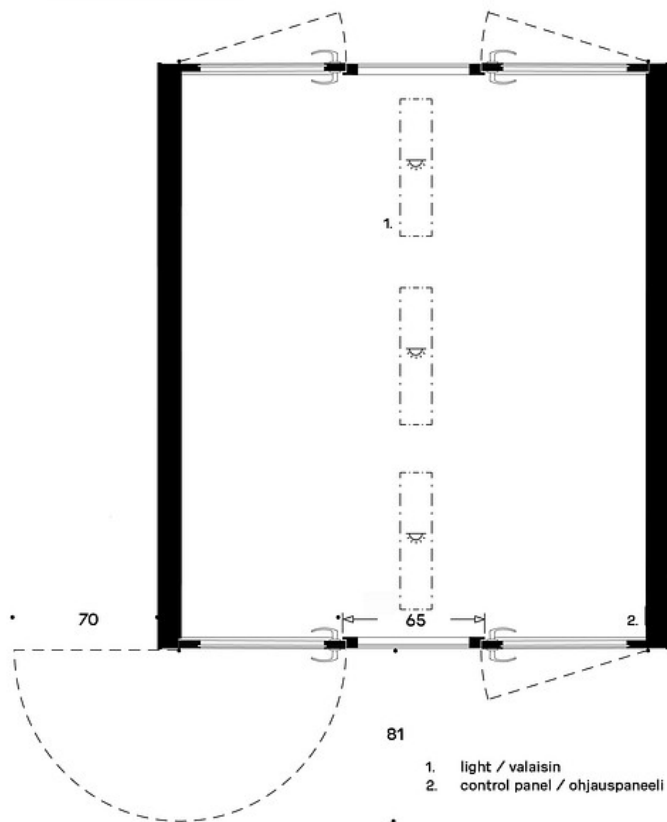

70

1

1

65

2

81

- 1. light / valaisin
- 2. control panel / ohjauspaneeli